



## SAMURAI EDGE SERIES GRIPS

MODELS:

ORIGINAL WALNUT • ORIGINAL WALNUT DIY KIT • BARRY BURTON STYLE (PLASTIC) • BARRY BURTON VER. II



## USER GUIDE

## Introduction:

A Kendo Custom Shop exclusive, the **Samurai Edge Series Grips** by COLLECTOR DESIGN WERKS are the highest quality and most faithfully reproduced Samurai Edge style presentation grips based on the original *Resident Evil* game series. We recommend reading this guide to ensure full enjoyment and usage of your grips.

**WARNING:** Ensure the firearm is unloaded and safety checked before performing any work.

## Section 1: Compatibility Review

- 1.1 This product is designed for Beretta 92/96, M9, M9A1 series pistols that uses standard, full size grips, this product is not compatible with models equipped with compact frames, frame mount safety/decocker levers, Vertec style grips, and/or heel magazine release).
- 1.2 Your frame must have a flat style hammer spring plug installed. If your frame has a lanyard loop style hammer spring plug, you must replace it first before proceeding further.

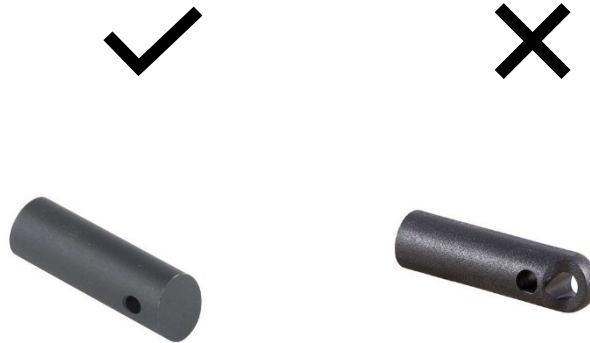

## Section 2: Installation

- 2.1 Note that the S.E. grips are uniquely designed in that each grip panel consists of two parts, the panel, and the panel insert. \*
- 2.2 With the factory grips removed, fit the S.E. grip panel to the frame by aligning the screw holes. The grips are pre-fitted and should be seated fully onto the frame.
- 2.3 Fit the corresponding panel insert into the grip panel cavity by aligning the grip screw holes.
- 2.4 Reinstall the grip screws but DO NOT use the washers, and do not over torque.
- 2.5 Repeat steps 2.3~2.5 for both sides.

## Section 3: Function & Safety Inspection

- 3.1 Perform a final function/safety check of firearm and ensure all operations are smooth without any signs of resistance or binding.
- 3.2 Installation Complete, enjoy your newly enhanced **Samurai Edge Barry Burton Model!**

## Section 4: DIY Kit Tips & Recommendations

- 4.1 Use 220 grit sandpaper with a sanding block to debur and sand the surface until smooth. Take care to sand along the contour of the grip and do not round off edges.
- 4.2 Apply wood stain (We recommend Minwax® Gunstock 231) until fully covered, brush off excess stain and allow to fully absorb and dry overnight.
- 4.3 Apply varnish (We recommend Minwax® Fast Drying Oil Based Polyurethane Clear Satin, Aerosol), apply 3~5 coats and allow to dry overnight
- 4.4 Lightly sand with 320 or higher grit sandpaper to remove any imperfections and apply 2~3 more coats to finish. Repeat as necessary.

Section 5: Wood Care

5.1 Avoid contact with cleaning solvent or excessive oil on the wood grips as it may cause damage to finish.

\*Not applicable to Barry Burton Ver. II Model.

FIG.1

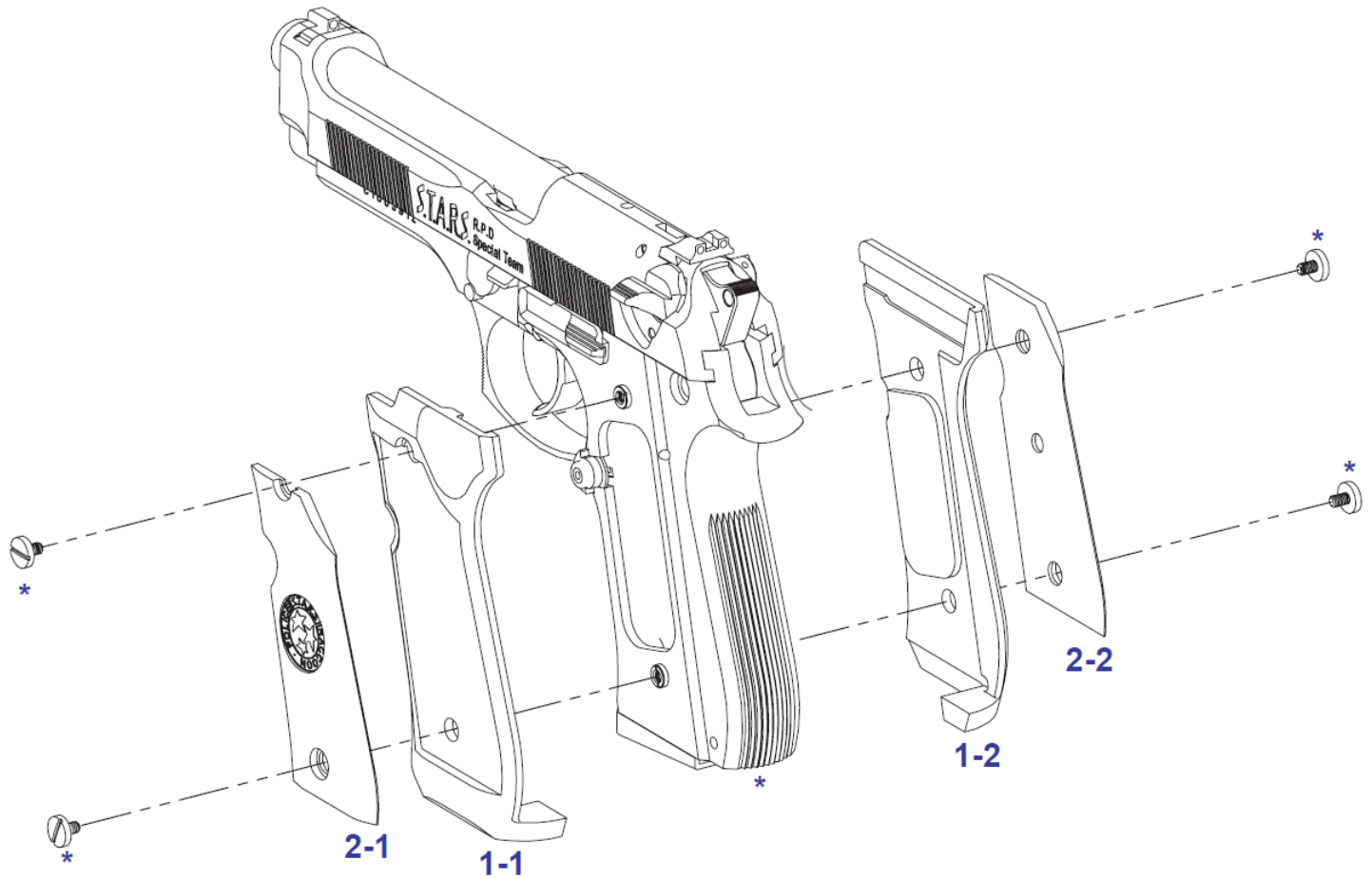

PARTS LIST		
NO.	PART NAME	QTY
1-1	GRIP PANEL, L	1
1-2	GRIP PANEL, R	1
2-1	PANEL INSERT, L	1
2-2	PANEL INSERT, R	1
4**	MEDALLION	2

\*User provided.

\*\*Optional feature.